

## Hardware Installation

- 1 Power off the router.
- 2 Insert the SIM card (from your mobile network operator) into the SIM card compartment located on the bottom panel of the router.

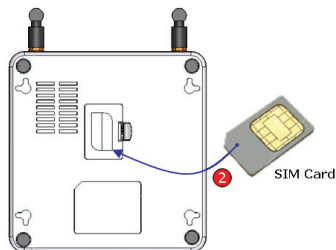

- 3 Connect the RJ45 cable from the router's LAN port to your computer.
- 4 Connect one end of the power adapter to the router's PWR port and the other end to the electrical wall outlet.

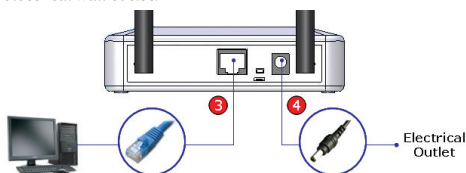

- 5 Power on the router.

## Configuration

- 1 To access the web-based utility, type "http://192.168.0.1" in your web browser and press "Enter".

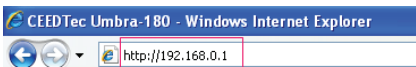

- 2 When prompted to login, type "admin" in both the User name and Password fields, and then click on the "OK" button.



**NEXT PAGE >>**

- 3** In the **Basic > HSDPA** webpage, depending on your mobile network operator, you may need to enter the following information:
- User Name
  - Password
  - APN Name
  - PIN Code

APN Configuration

User Name :	<input type="text"/>
Password :	<input type="password"/>
Dial Number :	<input type="text" value="*99#"/>
APN Name :	<input type="text"/>
PDP Type :	<input checked="" type="radio"/> IP <input type="radio"/> PPP
PDP Address :	<input type="text"/> . <input type="text"/> . <input type="text"/> . <input type="text"/>
PIN Code :	<input type="text"/>

- 4** Leave other settings as defaults unless specified by your mobile network operator (**Note:** some settings are empty by default).
- 5** If you have flat rate Internet access and you want the router to automatically connect to the Internet every time it is powered on, select “Enable” for “Auto Connect”.

Connection Settings

Connection Status :	Disconnected
Auto Connect :	<input checked="" type="radio"/> Enable <input type="radio"/> Disable
Disconnect after idle for :	<input type="text" value="0"/> min (0 - Never Disconnect)

- 6** Click on the “Submit” button to save the changes.
- 7** To change the Network Name (SSID) for your wireless network, go to the webpage **Basic > Wireless**.
- 8** The default SSID is “umbra180”. You may want to change the SSID if:
- You want to use your own preferred name.
  - Another wireless network operating in your area has already been using the default SSID.

Wireless Settings

Network Name (SSID) :	<input type="text" value="umbra180"/>
Channel :	<input type="text" value="11"/>
Security Mode :	<input type="text" value="None"/>

- 9** You are encouraged to turn on the security for your wireless network. To do that, please refer to **Wireless Settings** section in the User Guide.
- 10** If you do change any settings on this webpage, click on the “Submit” button to save the changes.
- 11** Reset the router by powering it off and then power it on again.
- 12** **Congratulations** - you have successfully configured your router!